

MOBILE DUST SUPPRESSION

Water Cart Series
ISO Hydraulic Driven

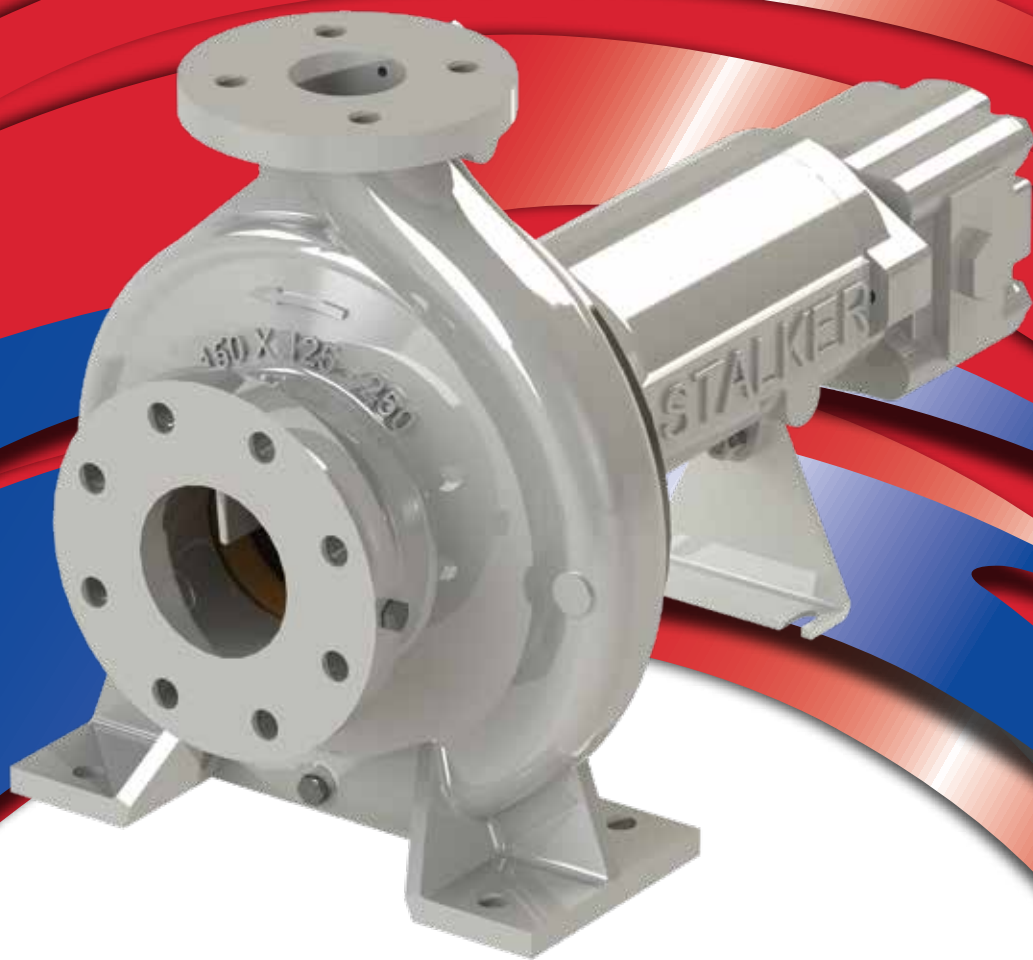

STALKER PUMPS

A DIVISION OF MALCOLM THOMPSON PUMPS

About us

Leaders in industrial pumps

ABOUT US

Established in 1923, Stalker Pumps is an Australian owned company dedicated to delivering innovative, reliable and robust pumping solutions to the Australian and global markets.

Engineered and manufactured in Australia to the highest quality standards, Stalker Pumps are legendary for their ability to operate at their fullest capacity, even in the most challenging of environments.

With industry experience spanning over 90 years, Stalker Pumps have served faithfully in the most testing environments, with a proven track record across almost every major industry including Mining, Agriculture, Oil & Gas, Civil & Marine Construction and Manufacturing.

With an enviable reputation for manufacturing rugged, dependable pumping systems, Stalker Pumps continues to lead the way for quality workmanship and after-sales service. With ongoing investments in research and development, Stalker Pumps is perfectly positioned to continue being a leader within the Australian pump industry.

If innovation, reliability and customer service really matters, then the solution is Stalker Pumps.



Table of Contents

Features	2
Pump Curves	3
4600 Series	4
4700 Series	5
6300 Series	6
6400 Series	7
7000 Series	8
Dimensions	9
Pump Assembly	10
Spare Listing	11

Features

Hydraulic Close Coupled Arrangement

Mechanical Seal

- Standard Car/Cer/Nit fitted
- Optional upgrades
 - SiC/SiC/Nit
 - SiC/SiC/Vit
 - API flush plans 11 and 31
- Further options available on request

Deep Groove Ball Bearings

- Assist in handling axial and radial loads of impeller, reducing load transfer to motor shaft providing better motor life

Double Spigot Impeller

- Fitted wear rings optional extra
- Taper shaft and woodruff key mounted impeller

Bearing Pedestal

- Hydraulic close coupled pedestal is a version of Stalker standard ISO bearing pedestal, which provides interchangeability of bearings & lip seals, between standard ISO and Hydraulic version. This allows for less spares holding on site

Table E Flanges Standard

- Optional ANSI and DIN flanges

Materials of Construction

- Standard Cast Iron/Cast Iron/Stainless Steel
- Other materials and ceramic coating options available on request

2 Bolt SAE Flange Mounted Easy On / Easy Off Hydraulic Motor

- Quick coupling arrangement allows for quick motor mounting and replacement for ease of service.
- Hydraulic motor mounted directly (close coupled) on bearing pedestal end, eliminating alignment issues

Heavy Duty Cast Feet on Volute

- ISO standard footprint

Spline Shaft Drive Arrangement

- Spline shaft drive enables even distribution of shaft loading and power transfer
- Eliminates axial load transfer to motor shaft elongating motor life

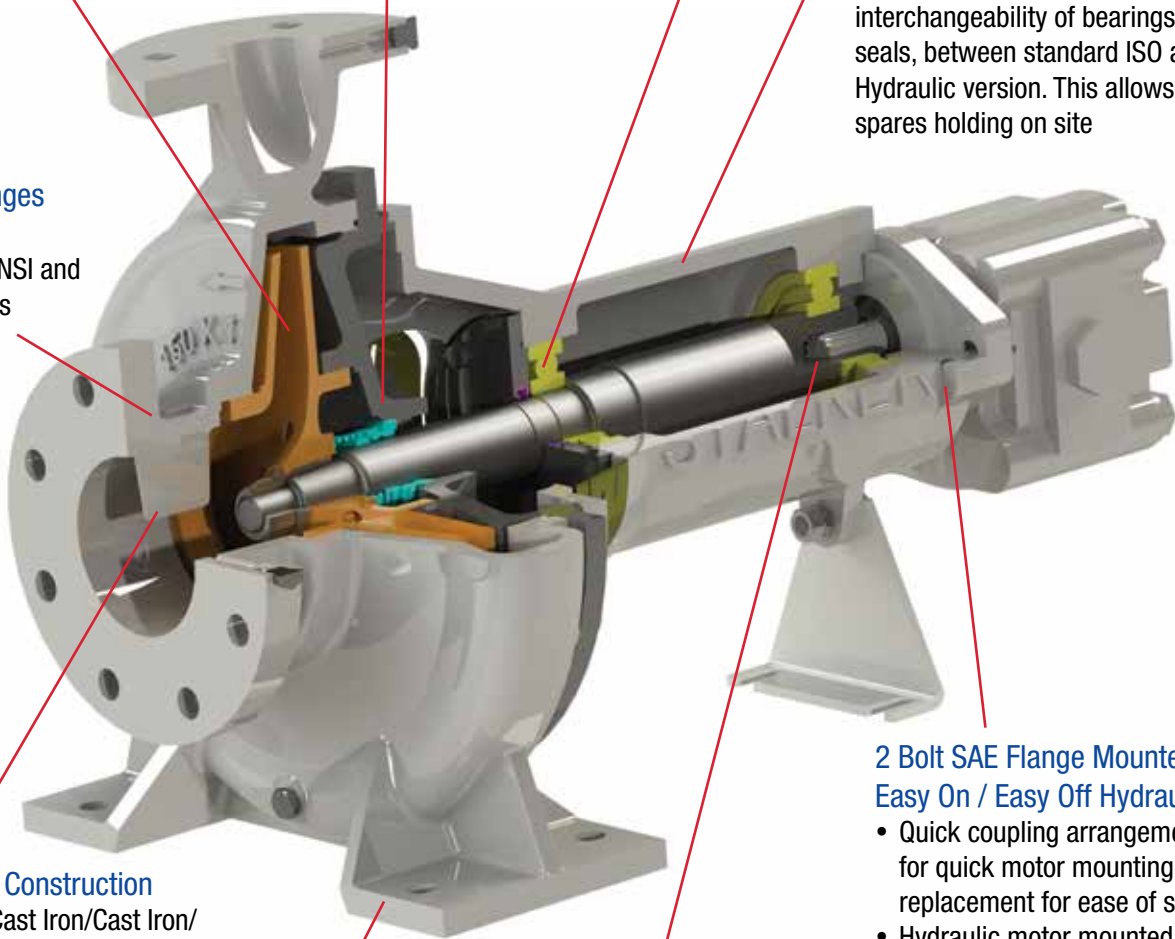

Pump Curves

Pump Selection Chart

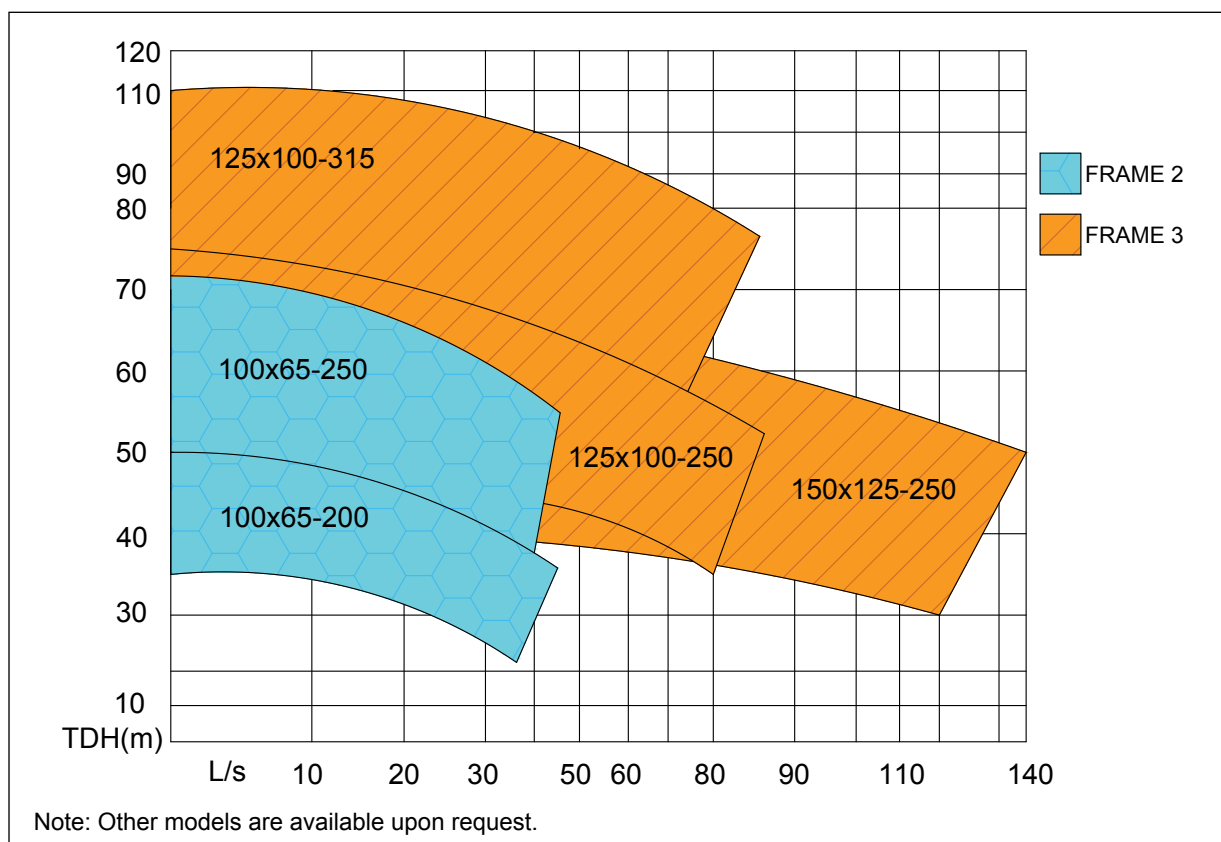

Material Options

Construction	Volute / Back-Plate	Impeller	Shaft	Mechanical Seal
CI/CI/SS	Cast Iron	Cast Iron	431 Stainless Steel	Carbon / Ceramic / Nitrile
CI/BR/SS	Cast Iron	Zinc-Free Bronze	431 Stainless Steel	Carbon / Ceramic / Nitrile
CI/SS/SS	Cast Iron	316 Stainless Steel	431 Stainless Steel	Carbon / Ceramic / Nitrile

4600 Series

Pump Model 100 x 65 - 200

Pump Performance Data

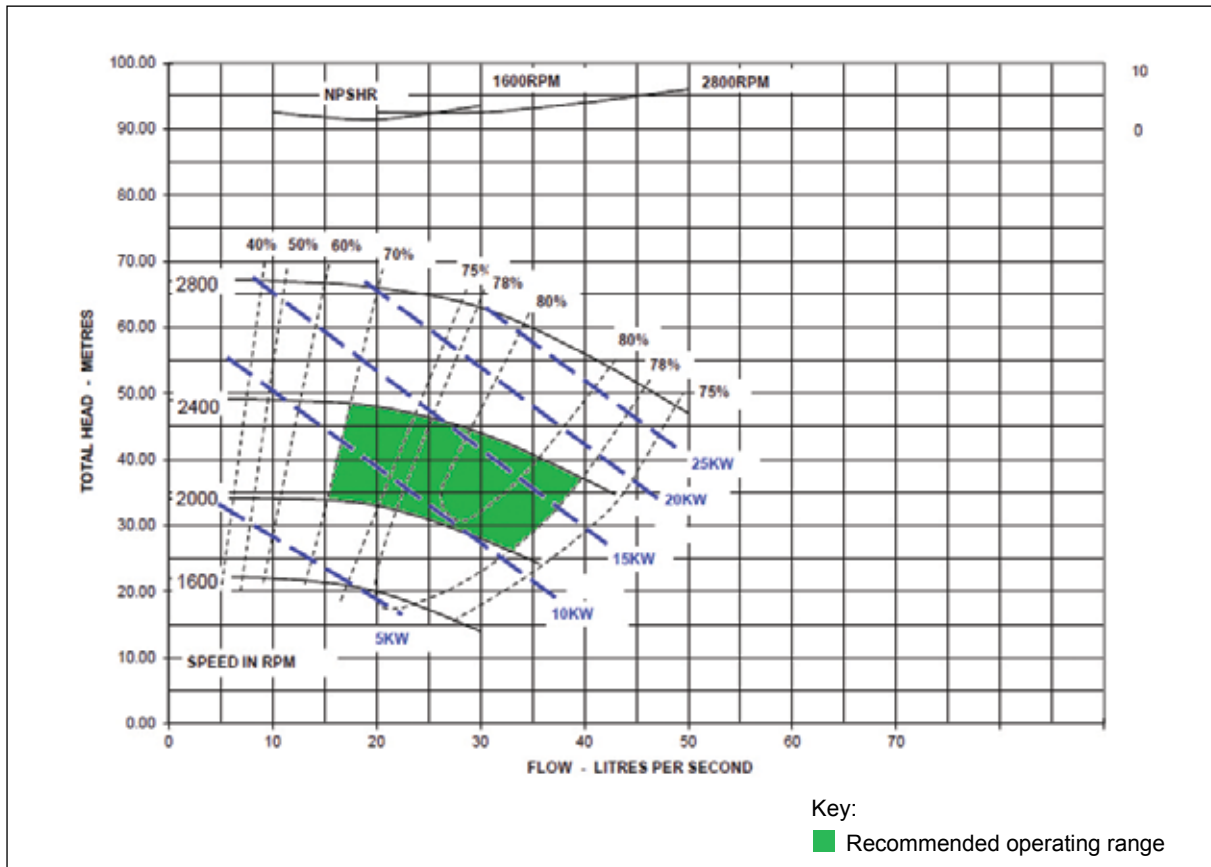

Materials of Construction

Pump Casing (Volute): Cast Iron
Casing Cover (Back Plate): Cast Iron
Impeller: Cast Iron
Pump Shaft: Stainless Steel 431
Fasteners: Grade 8.8 Zinc Plated
Mechanical Seal: Carbon/Ceramic/Nitrile

Design Details

Pump Type: ISO End Suction Centrifugal
Design: Back Pullout
Suction Size: 100 NB AS2129 Table E
Discharge Size: 65 NB AS2129 Table E
Impeller Type: Closed
Recommended Operating Speed: 2000 RPM to 2400 RPM
Flow Range: 15 to 40 L/s
Head Range: 26 to 48 m

Hydraulic Drive Details

Medium speed, medium pressure

Model: GM 130A
Output Power: 20.5kW
Oil Flow: 106 litres/min
Operating Speed: 2000 RPM
Output Torque: 97Nm
Gear Size-Inches: 1½
Motor Displacement: 40.4cc/rev

High speed, high pressure

Model: GM 230A
Output Power: 36.7kW
Oil Flow: 126 litres/min
Operating Speed: 2400 RPM
Output Torque: 145Nm
Gear Size-Inches: 1½
Motor Displacement: 40.4cc/rev

4700 Series

Pump Model 100 x 65 - 250

Pump Performance Data

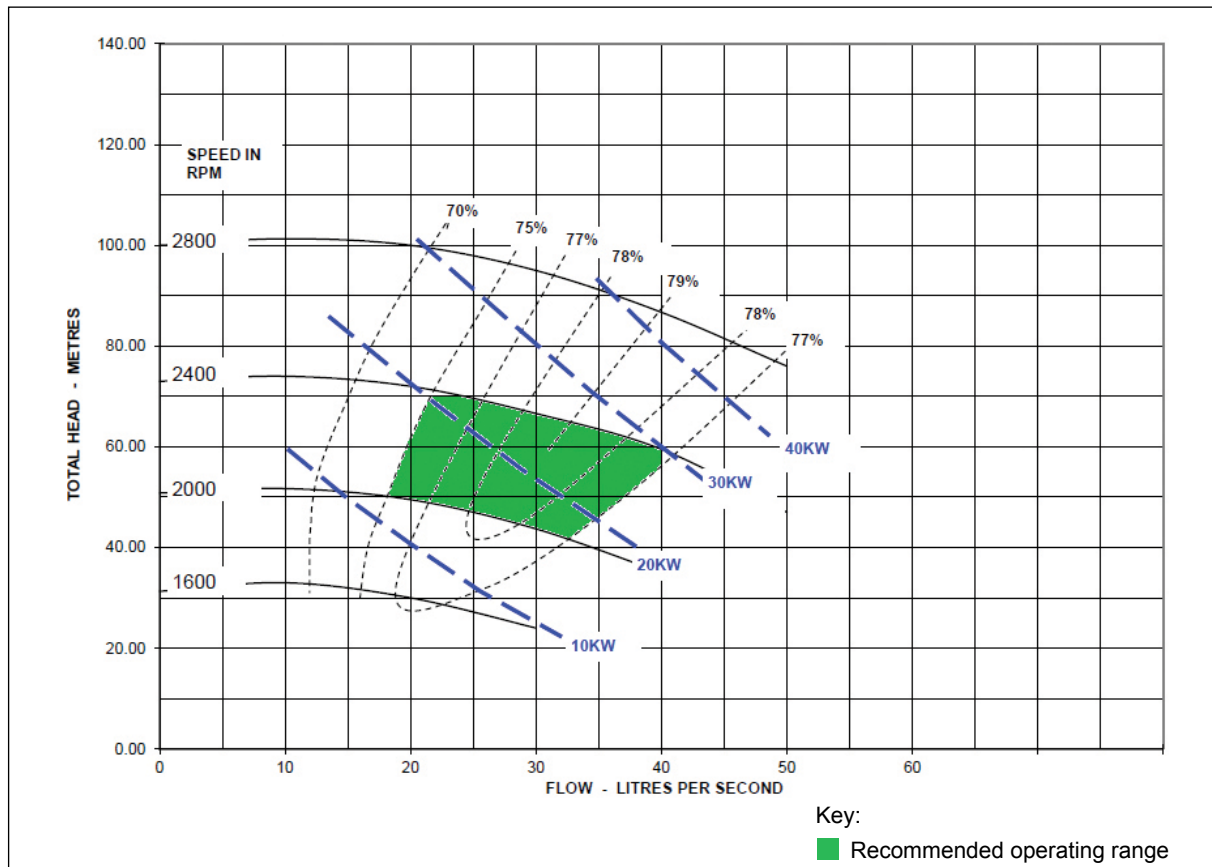

Materials of Construction

Pump Casing (Volute): Cast Iron
Casing Cover (Back Plate): Cast Iron
Impeller: Cast Iron
Pump Shaft: Stainless Steel 431
Fasteners: Grade 8.8 Zinc Plated
Mechanical Seal: Carbon/Ceramic/Nitrile

Design Details

Pump Type: ISO End Suction Centrifugal
Design: Back Pullout
Suction Size: 100 NB AS2129 Table E
Discharge Size: 65 NB AS2129 Table E
Impeller Type: Closed
Recommended Operating Speed: 2000 RPM to 2400 RPM
Flow Range: 18 to 41 L/s
Head Range: 42 to 72 m

Hydraulic Drive Details

Medium speed, medium pressure

Model: GM 130A
Output Power: 26.9kW
Oil Flow: 142 litres/min
Operating Speed: 2000 RPM
Output Torque: 128Nm
Gear Size-Inches: 2
Motor Displacement: 56.5cc/rev

High speed, high pressure

Model: GM 230A
Output Power: 48.2kW
Oil Flow: 167 litres/min
Operating Speed: 2400 RPM
Output Torque: 191Nm
Gear Size-Inches: 2
Motor Displacement: 64.6cc/rev

6300 Series

Pump Model 125 x 100 - 250

Pump Performance Data

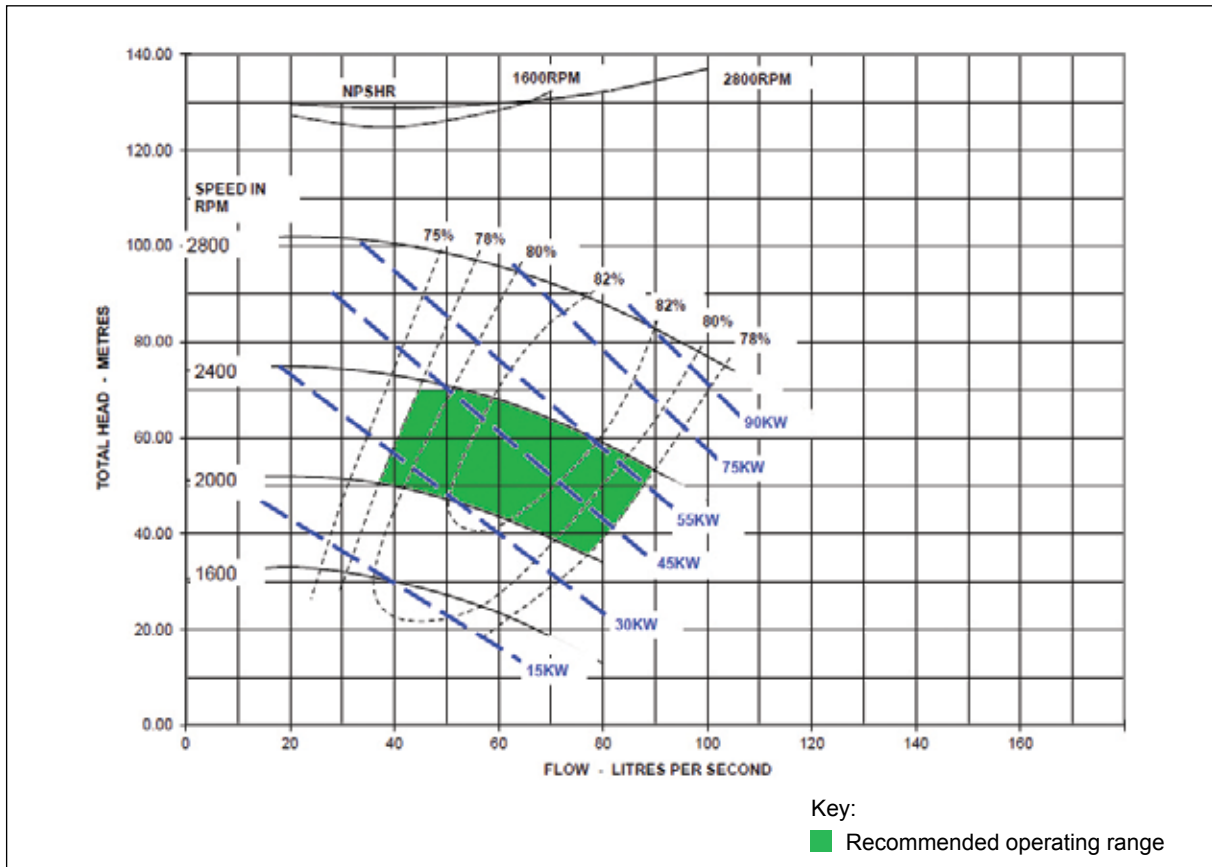

Materials of Construction

Pump Casing (Volute): Cast Iron
Casing Cover (Back Plate): Cast Iron
Impeller: Cast Iron
Pump Shaft: Stainless Steel 431
Fasteners: Grade 8.8 Zinc Plated
Mechanical Seal: Carbon/Ceramic/Nitrile

Design Details

Pump Type: ISO End Suction Centrifugal
Design: Back Pullout
Suction Size: 125 NB AS2129 Table E
Discharge Size: 100 NB AS2129 Table E
Impeller Type: Closed
Recommended Operating Speed: 2000 RPM to 2400 RPM
Flow Range: 37 to 90 L/s
Head Range: 36 to 72 m

Hydraulic Drive Details

Medium speed, medium pressure

Model: GM 175C
Output Power: 46.2kW
Oil Flow: 297 litres/min
Operating Speed: 2000 RPM
Output Torque: 255Nm
Gear Size-Inches: 2
Motor Displacement: 134.4cc/rev

High speed, high pressure

Model: GM 230A
Output Power: 98.6kW
Oil Flow: 303 litres/min
Operating Speed: 2400 RPM
Output Torque: 392Nm
Gear Size-Inches: 2
Motor Displacement: 118cc/rev

6400 Series

Pump Model 125 x 100 - 315

Pump Performance Data

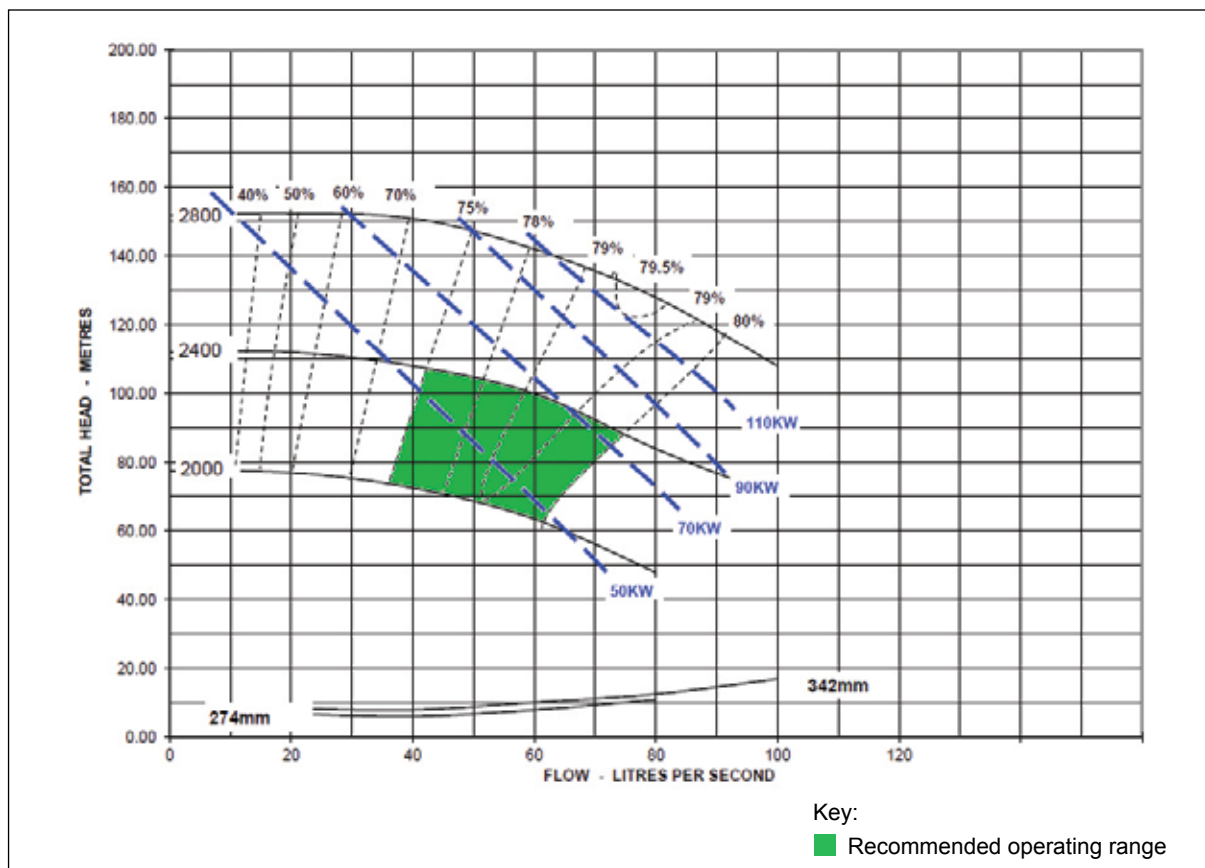

Materials of Construction

Pump Casing (Volute): Cast Iron
Casing Cover (Back Plate): Cast Iron
Impeller: Cast Iron
Pump Shaft: Stainless Steel 431
Fasteners: Grade 8.8 Zinc Plated
Mechanical Seal: Carbon/Ceramic/Nitrile

Design Details

Pump Type: ISO End Suction Centrifugal
Design: Back Pullout
Suction Size: 125 NB AS2129 Table E
Discharge Size: 100 NB AS2129 Table E
Impeller Type: Closed
Recommended Operating Speed: 2000 to 2400 RPM
Flow Range: 37 to 75 L/s
Head Range: 62 to 108 m

Hydraulic Drive Details

Medium speed, medium pressure

Model: GM 176C
Output Power: 81.7kW
Oil Flow: 365 litres/min
Operating Speed: 2000 RPM
Output Torque: 389Nm
Gear Size-Inches: 2½
Motor Displacement: 168cc/rev

High speed, high pressure

Model: GM 265A
Output Power: 126kW
Oil Flow: 337 litres/min
Operating Speed: 2400 RPM
Output Torque: 501Nm
Gear Size-Inches: 2½
Motor Displacement: 147.5cc/rev

7000 Series

Pump Model 150 x 125 - 250

Pump Performance Data

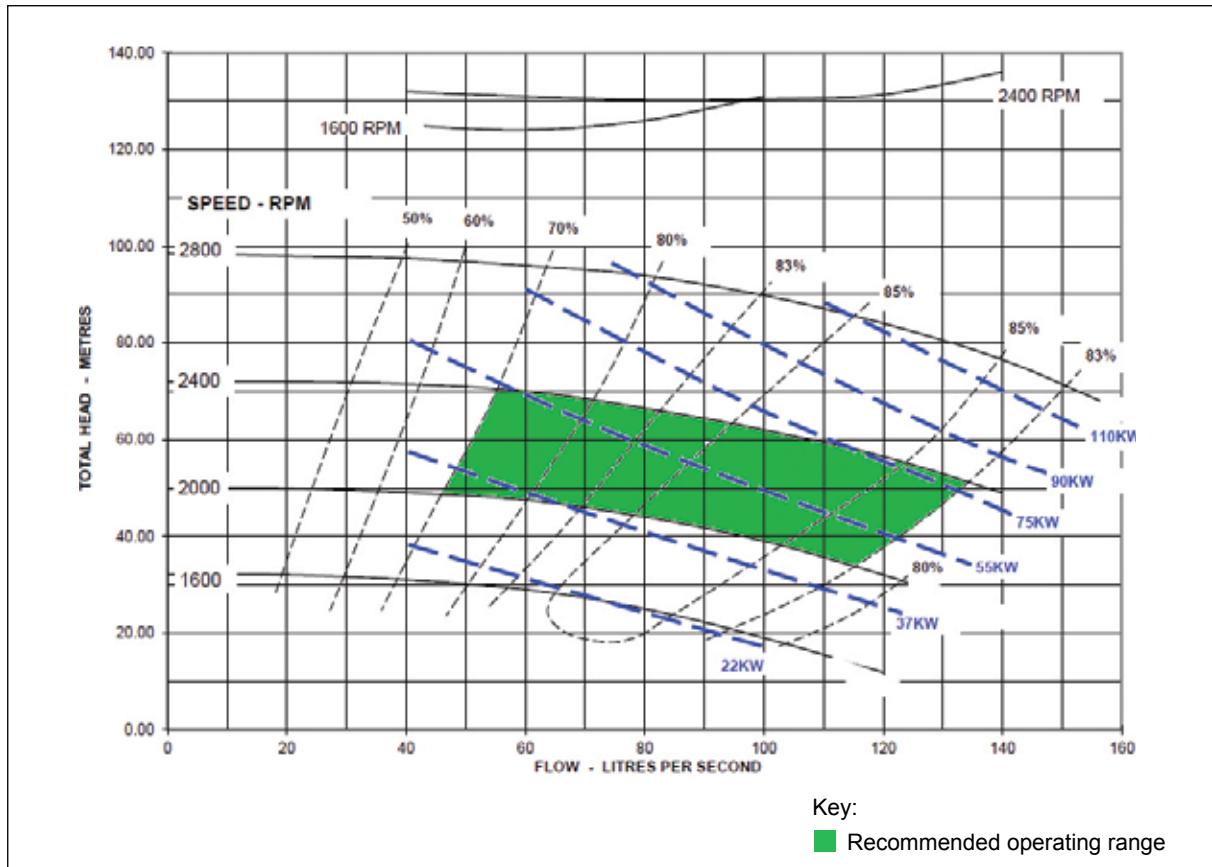

Materials of Construction

Pump Casing (Volute): Cast Iron
Casing Cover (Back Plate): Cast Iron
Impeller: Cast Iron
Pump Shaft: Stainless Steel 431
Fasteners: Grade 8.8 Zinc Plated
Mechanical Seal: Carbon/Ceramic/Nitrile

Design Details

Pump Type: ISO End Suction Centrifugal
Design: Back Pullout
Suction Size: 150 NB AS2129 Table E
Discharge Size: 125 NB AS2129 Table E
Impeller Type: Closed
Recommended Operating Speed: 2000 RPM to 2400 RPM
Flow Range: 45 to 135 L/s
Head Range: 34 to 70 m

Hydraulic Drive Details

Medium speed, medium pressure

Model: GM 176C
Output Power: 81.7kW
Oil Flow: 365 litres/min
Operating Speed: 2000 RPM
Output Torque: 389Nm
Gear Size-Inches: 2½
Motor Displacement: 168cc/rev

High speed, high pressure

Model: GM 265A
Output Power: 126kW
Oil Flow: 337 litres/min
Operating Speed: 2400 RPM
Output Torque: 501Nm
Gear Size-Inches: 2½
Motor Displacement: 147.5cc/rev

ISO 2858 Hydraulic Driven

Dimensions

ISO 4600, 4700, 6300, 6400 and 7000 Hydraulic Series

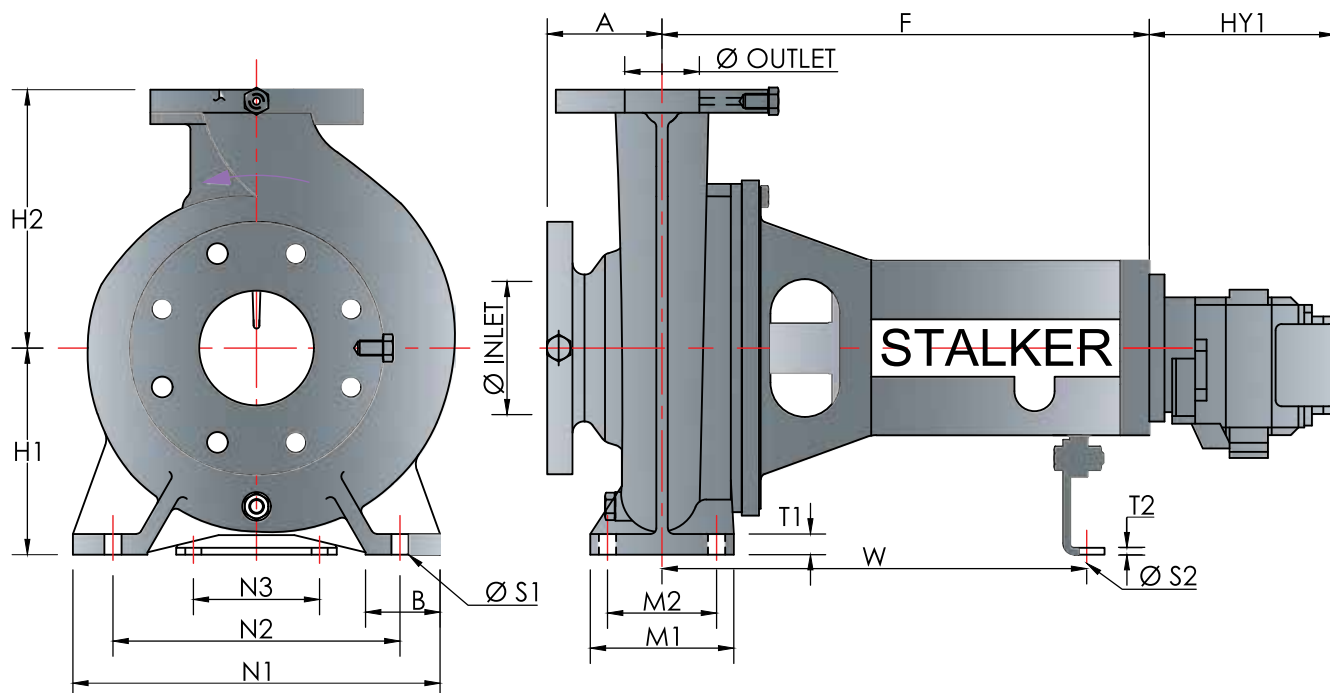

Stalker Series	Pump Size			Shaft No.	Pump Dimensions				Mounting Dimensions								Bolt Holes		Hydraulic Motor		
	INLET	OUTLET	IMP Ø		A	F	H1	H2	B	M1	M2	N1	N2	N3	T1	T2	W	S1	S2	HY1 2000 RPM Motor	HY1 2400 RPM Motor
4600	100	65	200	2	100	425	180	225	65	125	95	320	250	110	18	6	370	Ø15	Ø15	210	210
4700	100	65	250	2	125	425	200	250	80	160	120	360	280	110	16	6	370	Ø18	Ø15	201	223
6300	125	100	250	3	140	417	225	280	76	160	120	400	315	110	20	6	370	Ø18	Ø15	241	249
6400	125	100	315	3	140	417	250	315	75	160	120	390	315	110	20	6	370	Ø18	Ø15	241	249
7000	150	125	250	3	140	417	250	355	80	160	120	400	315	110	20	6	370	Ø18	Ø15	241	249

All dimensions are stated in millimetres

ISO 2858 Hydraulic Driven

Pump Assembly

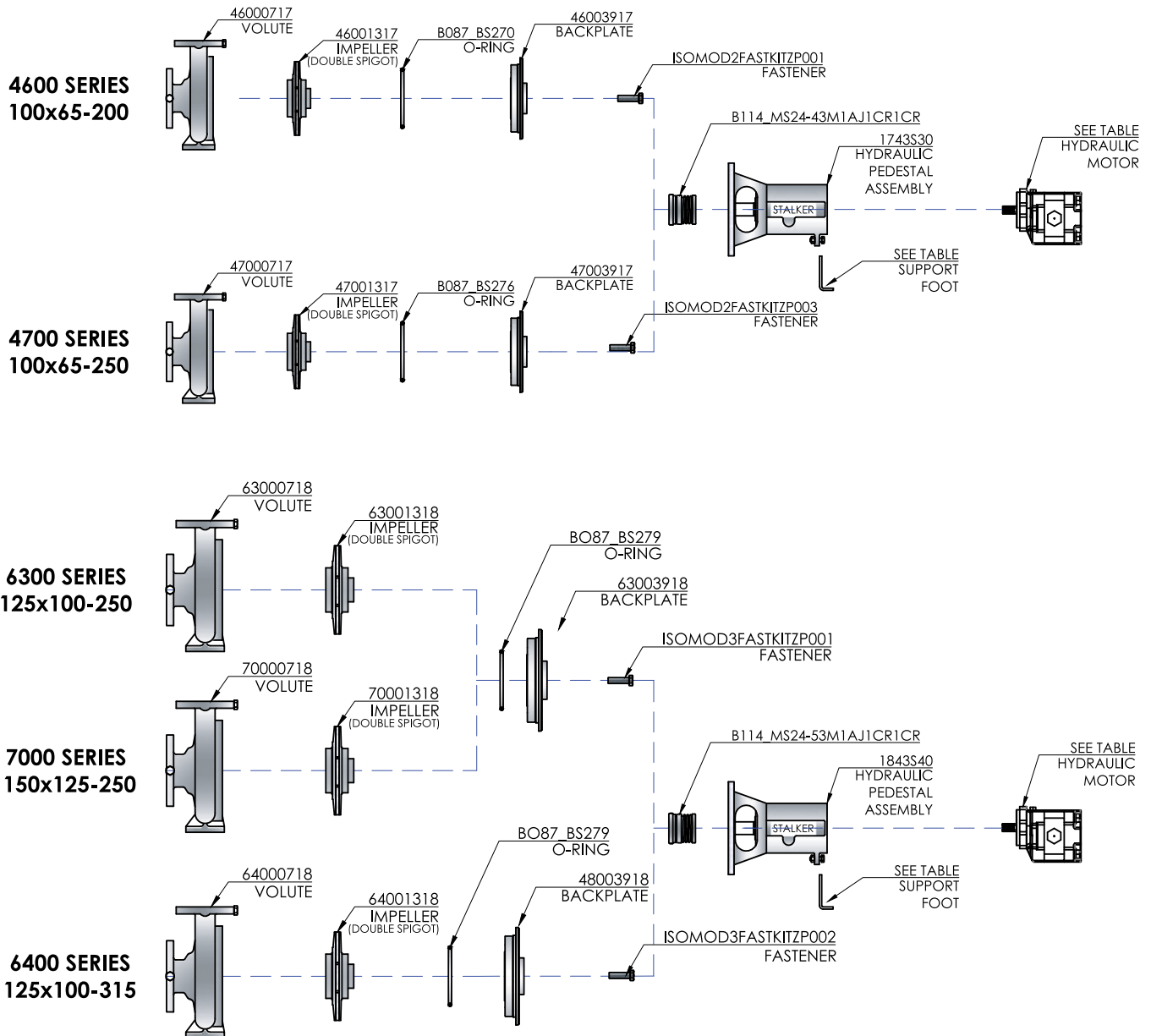

Hydraulic Motor Table

Stalker Series	ISO Pump	Hydraulic Motor @ 2000 RPM (Medium Speed)	Hydraulic Motor @ 2400 RPM (High Speed)	Support Foot Part No.
4600	100x65-200	GM130A	GM230A	B048_95x140x36
4700	100x65-250	GM130A	GM230A	B048_115x140x36
6300	125x100-250	GM175C	GM265A	B048_128x140x45
6400	125x100-315	GM176C	GM265A	B048_153x140x45
7000	150x125-250	GM176C	GM265A	B048_153x140x45

Spare Listing

Suits 4600, 4700 & 6300 Series

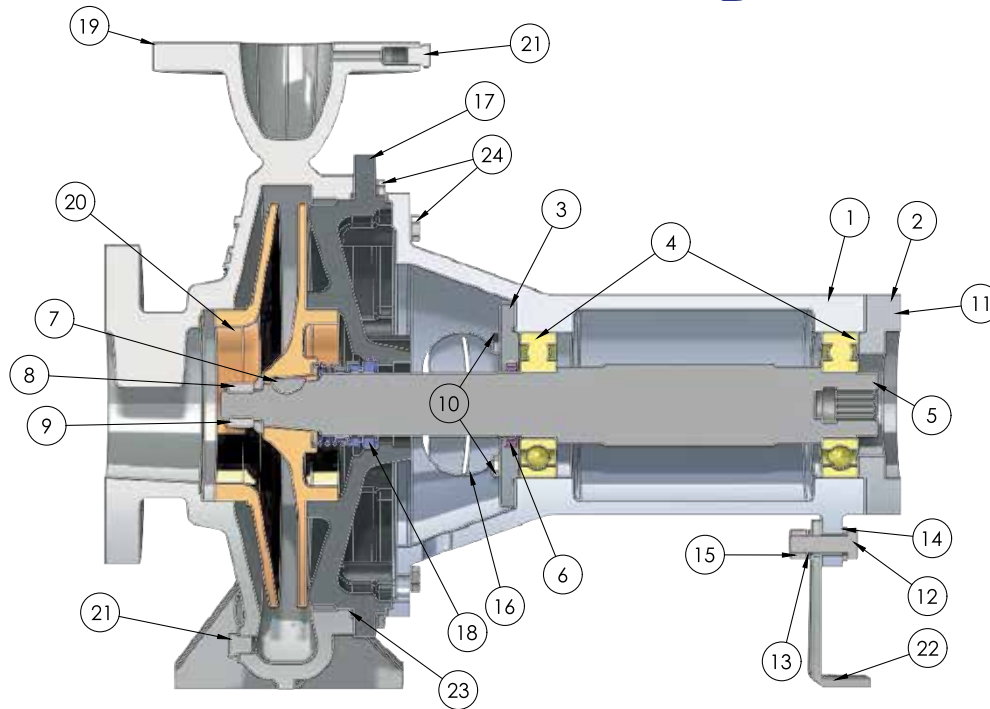

Position	Item Code	Description	Quantity
1	0000011701	ISO MODULE 2 PEDESTAL - CAST IRON	1
2	0000021701-HCC	REAR BEARING CAP TO SUIT CC HYD MOTOR - CAST IRON	1
3	0000031701	FRONT BEARING CAP - CAST IRON	1
4	B008_6309_2RS_C3	BEARING - 6309 2RS C3	2
5	0000191710-HCC	1"x SPLINED SHAFT TO SUIT ISO MODULE 2 - 431 SS	1
6	B115_OS12864	OIL SEAL - 44-58-8	1
7	B150_14x1G316WK	1/4" x 1" WOODRUFF KEY - 316SS	1
8	0000501706	IMPELLER WASHER TO SUIT ISO MODULE 2 SHAFT - 316SS	1
9	B082_20MG316NN	20M NYLOCK NUT - 316SS	1
10	B111_8x25MZPSS	M8x25mm ZINC-PLATED SET SCREW	4
11	B122_8X25MG316SHCS	M8x25mm SOCKET-HEAD SCREWS - 316SS (REAR BEARING CAP)	4
12	B011_12x40MZPB	M12x40mm ZINC-PLATED BOLT	1
13	B148_12MZPSW	M12 ZINC-PLATED SPRING WASHER	1
14	B147_12MZPW	M12 ZINC-PLATED WASHER	1
15	B082_12MZPN	M12 ZINC-PLATED NUT	1
16	B068_0000371712	BEARING HOUSING WINDOW COVER	2
17	As per page 10	ISO MODULE 2 BACK-PLATE - CAST IRON	1
18	As per page 10	MECHANICAL SEAL	1
19	As per page 10	ISO MODULE 2 VOLUTE - CAST IRON	1
20	As per page 10	ISO MODULE 2 IMPELLER	1
21	B098_14ZPTGP	1/4" ZINC-PLATED TAPER GAS PLUG	3
22	As per page 10	ISO PEDESTAL SUPPORT FOOT - MILD STEEL	1
23	As per page 10	CASING O-RING - NITRILE	1
24	B111_10x30MZPSS	M10x30mm ZINC-PLATED SET SCREWS	16

Spare Listing

Suits 6400 & 7000 Series

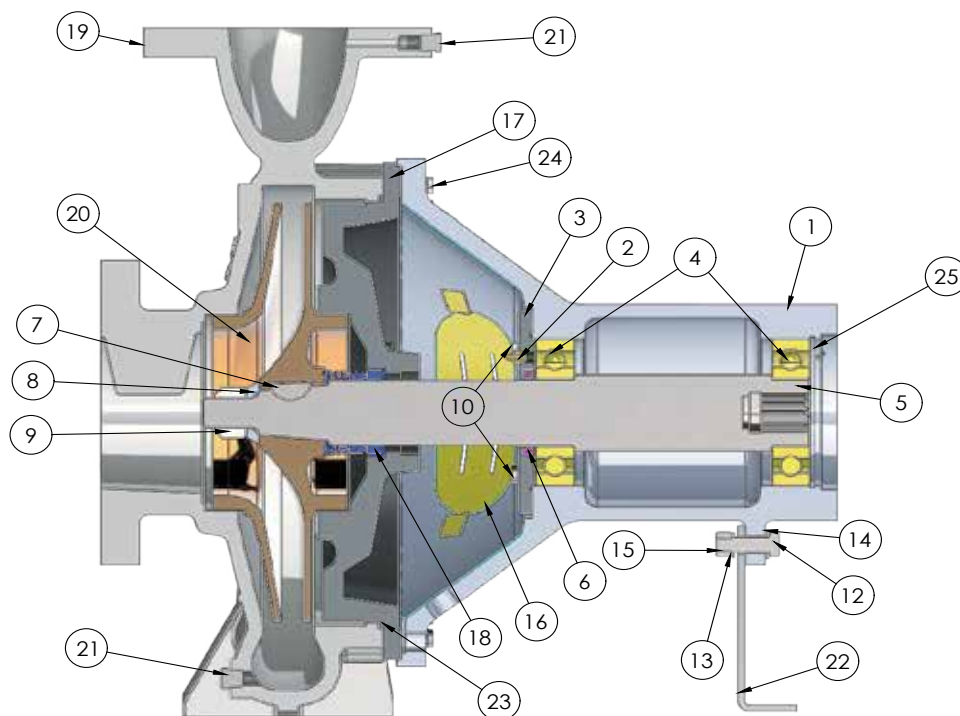

Position	Item Code	Description	Quantity
1	0000011801-HCC	ISO MODULE 3 PEDESTAL - SAE 2-BOLT FLANGE - CAST IRON	1
2	B081_GN_18	GREASE NIPPLE	1
3	0000031801	FRONT BEARING CAP - CAST IRON	1
4	B008_6311_2RS_C3	BEARING - 6311 2RS C3	2
5	0000191810-HCCR1	1.25" SPLINED SHAFT TO SUIT ISO MODULE 3 - 431 SS	1
6	B115_OS12612	OIL SEAL - 44-58-8	1
7	B150_516x1.14G316WK	1/4" x 1" WOODRUFF KEY - 316SS	1
8	0000501806	IMPELLER WASHER TO SUIT ISO MODULE 3 SHAFT - 316SS	1
9	B082_24MG316NN	24M NYLOCK NUT - 316SS	1
10	B111_8x25MZPSS	M8x25mm ZINC-PLATED SET SCREW	4
12	B011_12x40MZPB	M12x40mm ZINC-PLATED BOLT	1
13	B148_12MZPSW	M12 ZINC-PLATED SPRING WASHER	1
14	B147_12MZPW	M12 ZINC-PLATED WASHER	1
15	B082_12MZPN	M12 ZINC-PLATED NUT	1
16	B068_0000371812	BEARING HOUSING WINDOW COVER	2
17	As per page 10	ISO MODULE 3 BACK-PLATE - CAST IRON	1
18	As per page 10	MECHANICAL SEAL	1
19	As per page 10	ISO MODULE 3 VOLUTE - CAST IRON	1
20	As per page 10	ISO MODULE 3 IMPELLER	1
21	B098_14ZPTGP	1/4" ZINC-PLATED TAPER GAS PLUG	3
22	As per page 10	ISO PEDESTAL SUPPORT FOOT - MILD STEEL	1
23	As per page 10	CASING O-RING - NITRILE	1
24	B011_8x45MZPB	M8x45mm ZINC-PLATED SET SCREWS	8
25	B022_CIR-INT_120	120mm INTERNAL CIRCLIP	1



www.stalkerpumps.com.au
sales@stalkerpumps.com.au

Unit 1, 33 Colquhoun Road, Perth Airport WA 6105

Ph: 1800 290 573

Fax: +61 8 6254 2146

ABN 28 009 095 818

DISTRIBUTED BY

For information on these products or for any specialised requirements please contact your local Malcolm Thompson Pumps distributor or visit our website at www.mtp.com.au